

KEY

- PROPOSED NO WAITING AT ANY TIME
- EXISTING WAITING, LOADING AND PARKING RESTRICTIONS (WITH OR WITHOUT SYMBOLS)

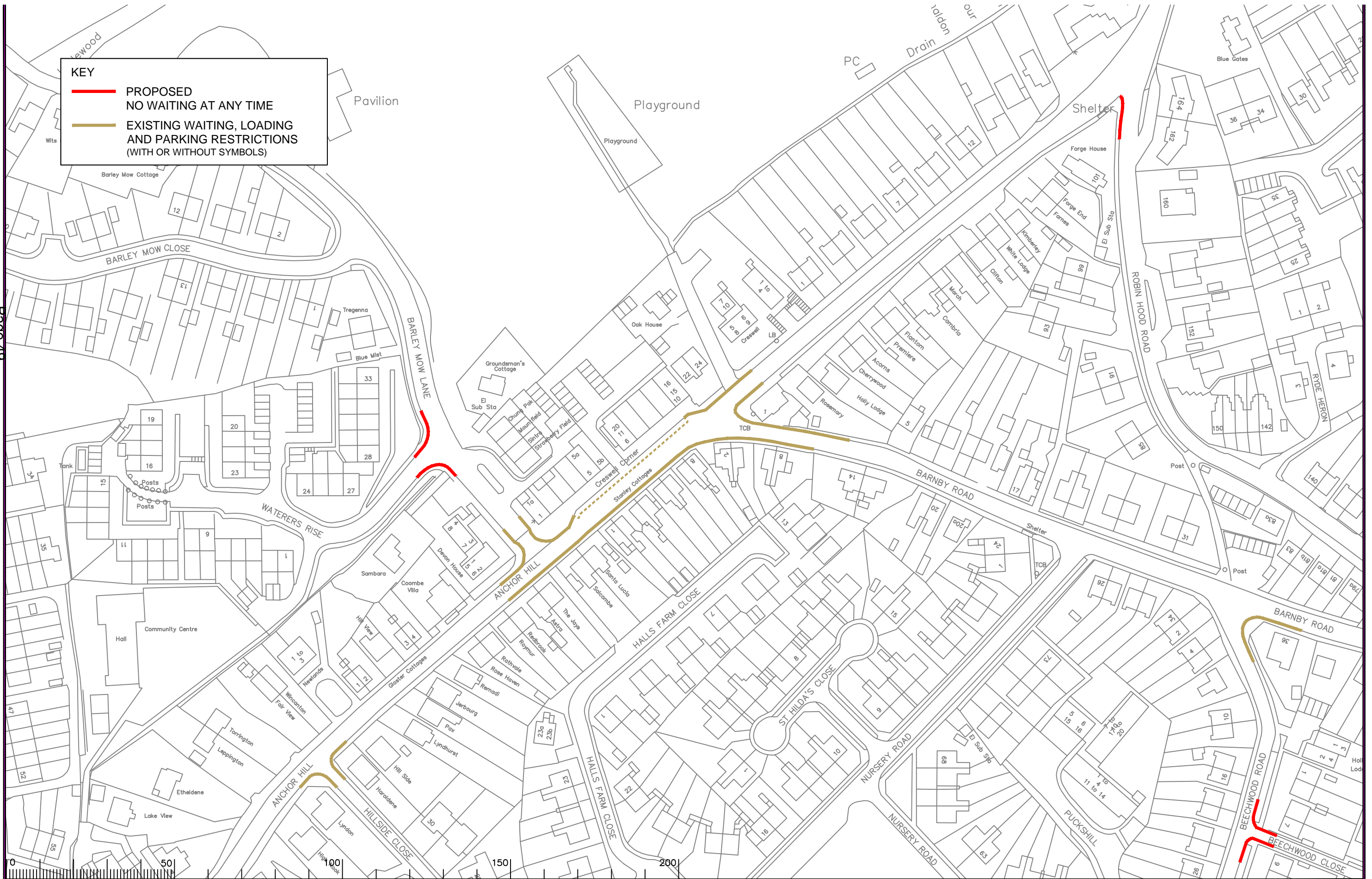

Notes

Rev.	Description	Drwn	Sig.	Date	Chkd	Sig.	Date	Appr	Sig.	Date
A	LINETYPES AMENDED	A.M	A.M	12.12.07	KP	KP	12.12.07	TPC	TPC	12.12.07
B	RESTRICTIONS AMENDED	CAH	CAH	01/11	JAR	JAR	01/11	TPC	TPC	01/11
C	RESTRICTIONS AMENDED	CAH	CAH	08.14	PW	PW	08.14	RH	RH	08.14
D	RESTRICTIONS AMENDED	CAH	CAH	11.15	PW	PW	11.15	RH	RH	11.15

Drwn	Sig.	Date	Chkd	Sig.	Date	Appr	Sig.	Date
A.M	A.M	12.12.07	KP	KP	12.12.07	TPC	TPC	12.12.07
CAH	CAH	01/11	JAR	JAR	01/11	TPC	TPC	01/11
CAH	CAH	08.14	PW	PW	08.14	RH	RH	08.14
CAH	CAH	11.15	PW	PW	11.15	RH	RH	11.15

North Point

Based upon the Ordnance Survey mapping with the permission of the Controller of Her Majesty's Stationary Office. Crown copyright. Unauthorised reproduction infringes Crown copyright and may lead to prosecution or civil proceedings. Surrey County Council LA 078872 1998.

Drawn by	Sig.	Date
SDC	SDC	05/05
Checked by	Sig.	Date
AM	AM	05/05
Approved by	Sig.	Date
TPC	TPC	05/05

Project

KNAPHILL DPE WOKING

IMPLEMENTED TRAFFIC ORDERS

SHEET 18 of

SURREY COUNTY COUNCIL
Sustainable Development

Project No. 3282/WOK
Contract Sheet No. 20018
Drawing No. 20018
Rev. D

Classification: PROPOSAL

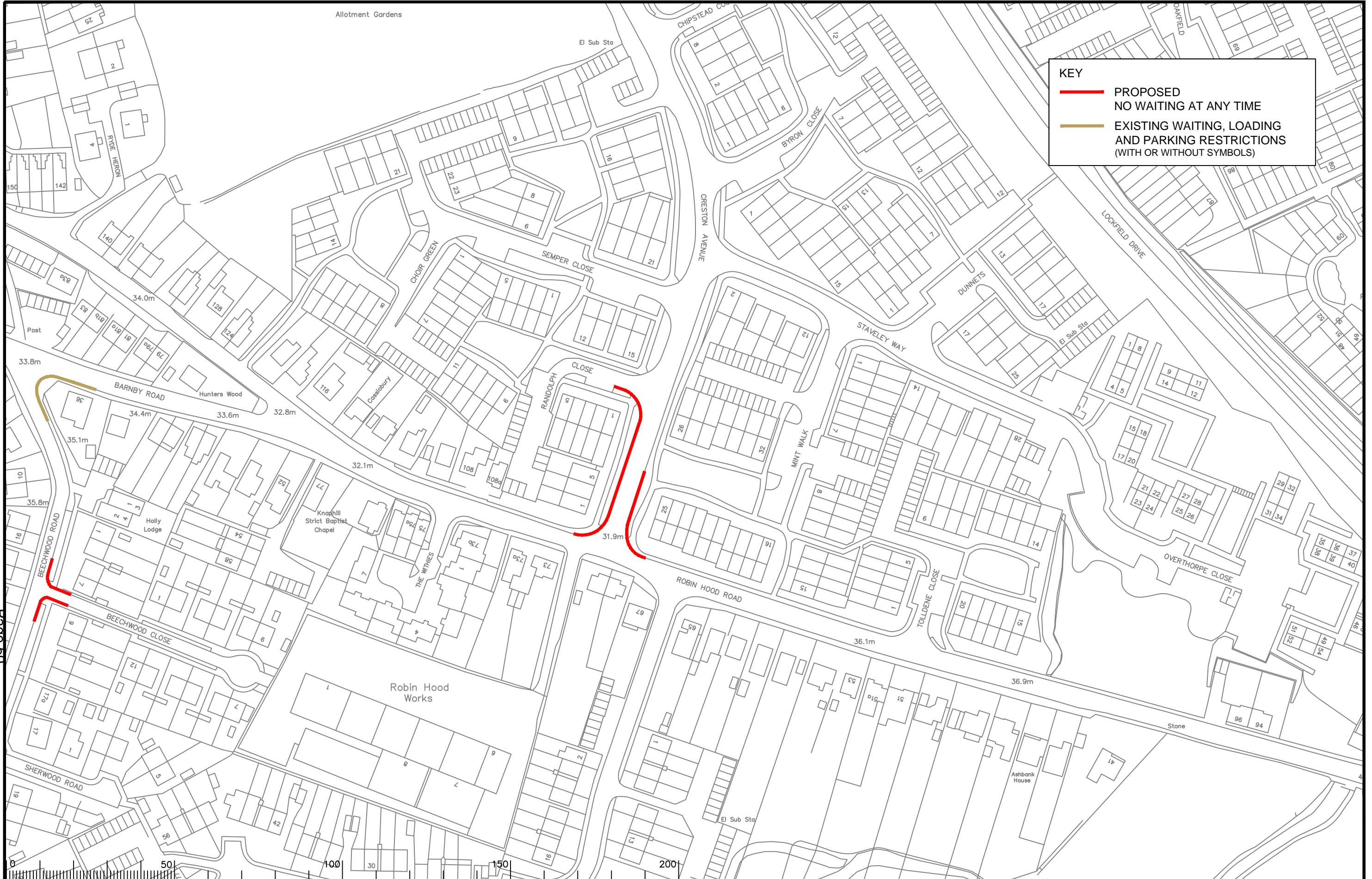

KEY

- PROPOSED NO WAITING AT ANY TIME
- EXISTING WAITING, LOADING AND PARKING RESTRICTIONS (WITH OR WITHOUT SYMBOLS)

Page 50

Notes

Rev.	Description	Drwn	Sig.	Date	Chkd	Sig.	Date	Appr	Sig.	Date

Rev.	Description	Drwn	Sig.	Date	Chkd	Sig.	Date	Appr	Sig.	Date

North Point

Drawn by	Sig.	Date
CAH	CAH	11.15
Checked by	Sig.	Date
PW	PW	11.15
Approved by	Sig.	Date
RH	RH	11.15

Project: KNAPHILL DPE WOKING

Implemented Traffic Orders

Scale: 1:1250

SURREY COUNTY COUNCIL
Sustainable Development
Head of Department: L. L. Lee
Tel: 01430 850000 Fax: 01430 850001

Project No.	3282/WOK
Contract Sheet No.	20115
Rev.	-
Classification	PROPOSAL

SHEET OF

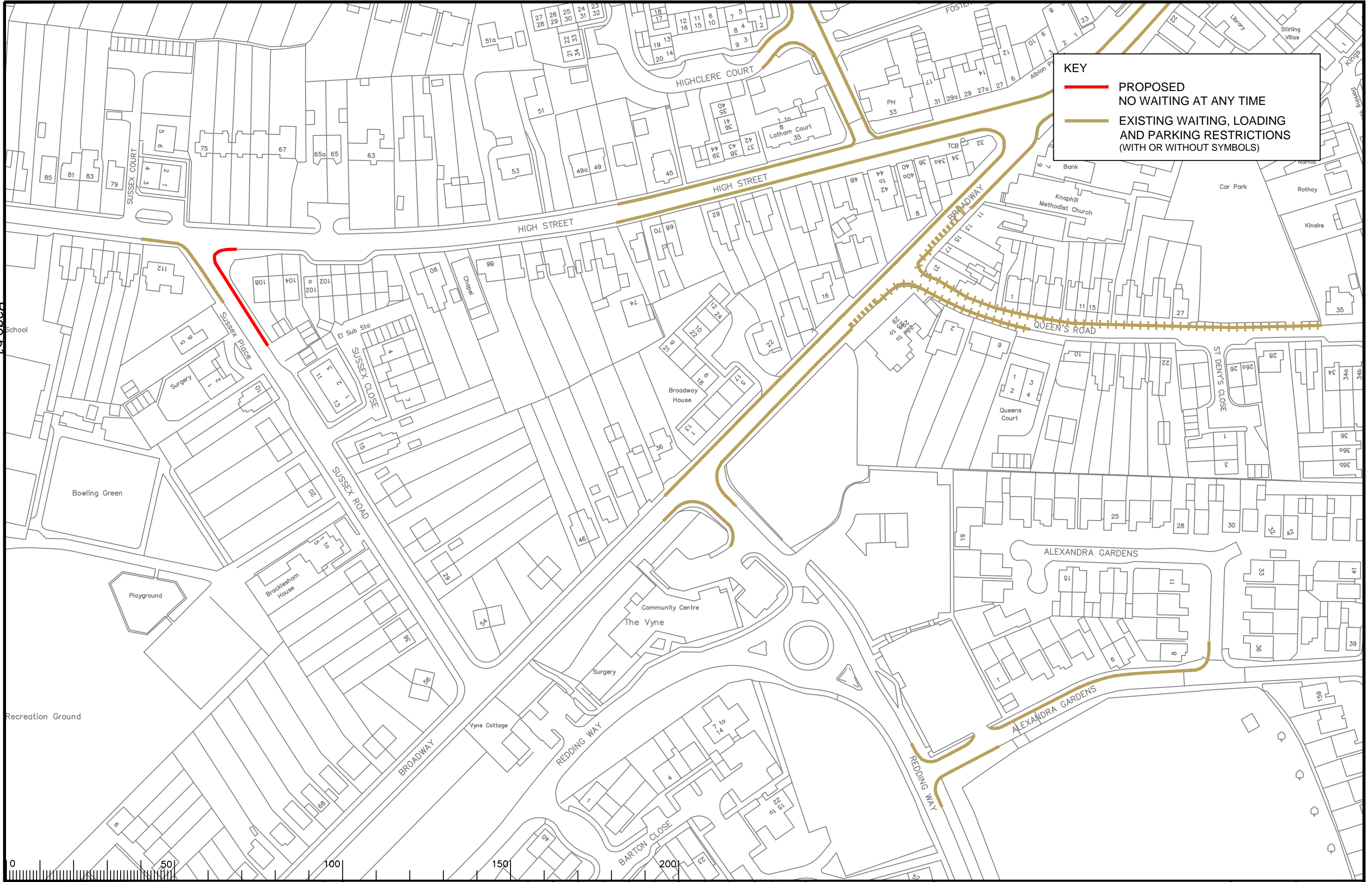

KEY

- PROPOSED NO WAITING AT ANY TIME
- EXISTING WAITING, LOADING AND PARKING RESTRICTIONS (WITH OR WITHOUT SYMBOLS)



Notes

Rev.	Description	Drwn	Sig.	Date	Chkd	Sig.	Date	Appr	Sig.	Date
A	LINE TYPES AMENDED	AJM	AJM	12.12.07	KP	KP	12.12.07	TPC	TPC	12.12.07
B	RESTRICTIONS AMENDED	CAH	CAH	08.14	PW	PW	08.14	RH	RH	08.14
C	RESTRICTIONS AMENDED	CAH	CAH	11.15	PW	PW	11.15	RH	RH	11.15

Rev.	Description	Drwn	Sig.	Date	Chkd	Sig.	Date	Appr	Sig.	Date
A	LINE TYPES AMENDED	AJM	AJM	12.12.07	KP	KP	12.12.07	TPC	TPC	12.12.07
B	RESTRICTIONS AMENDED	CAH	CAH	08.14	PW	PW	08.14	RH	RH	08.14
C	RESTRICTIONS AMENDED	CAH	CAH	11.15	PW	PW	11.15	RH	RH	11.15

North Point

Checked by	Sig.	Date
AM	AM	05/05
TPC	TPC	05/05

Project: **KNAPHILL DPE WOKING**

Implemented Traffic Orders

SHEET 20 of 101

SURREY COUNTY COUNCIL
Sustainable Development

Project No. 3282/WOK
Contract Sheet No. 20020
Drawing No. 20020
Rev. C
Classification: PROPOSAL

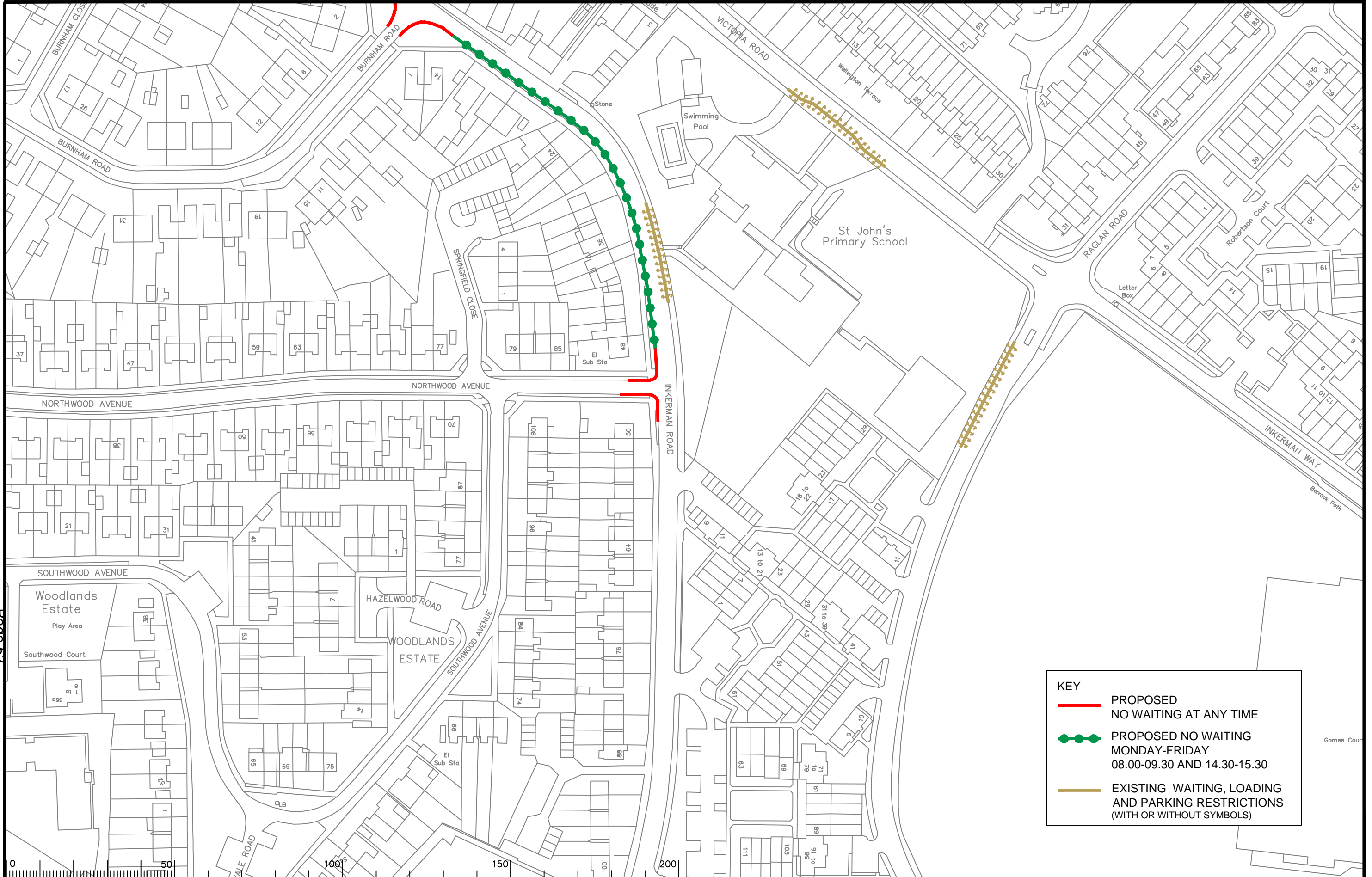

KEY

- PROPOSED NO WAITING AT ANY TIME
- PROPOSED NO WAITING MONDAY-FRIDAY 08.00-09.30 AND 14.30-15.30
- - - EXISTING WAITING, LOADING AND PARKING RESTRICTIONS (WITH OR WITHOUT SYMBOLS)

Notes

Rev.	Description	Drwn	Sig.	Date	Chkd	Sig.	Date	Appr	Sig.	Date
A	RESTRICTIONS AMENDED	CAH	CAH	05.13	JAR	JAR	05.13	RH	RH	05.13
B	RESTRICTIONS AMENDED	CAH	CAH	11.15	PW	PW	11.15	RH	RH	11.15

Rev.	Description	Drwn	Sig.	Date	Chkd	Sig.	Date	Appr	Sig.	Date
A	RESTRICTIONS AMENDED	CAH	CAH	05.13	JAR	JAR	05.13	RH	RH	05.13
B	RESTRICTIONS AMENDED	CAH	CAH	11.15	PW	PW	11.15	RH	RH	11.15

Scale 1:1250

North Point

Drawn by	Sig.	Date
SDC	SDC	05/05

Checked by	Sig.	Date
AM	AM	05/05

Approved by	Sig.	Date
TPC	TPC	05/05

Project: KNAPHILL DPE WOKING
 Drawing: IMPLEMENTED TRAFFIC ORDERS

SURREY COUNTY COUNCIL
 Sustainable Development

Project No. 3282/WOK
 Contract Sheet No. 20022
 Drawing No. 20022
 Rev. B
 Classification: PROPOSAL

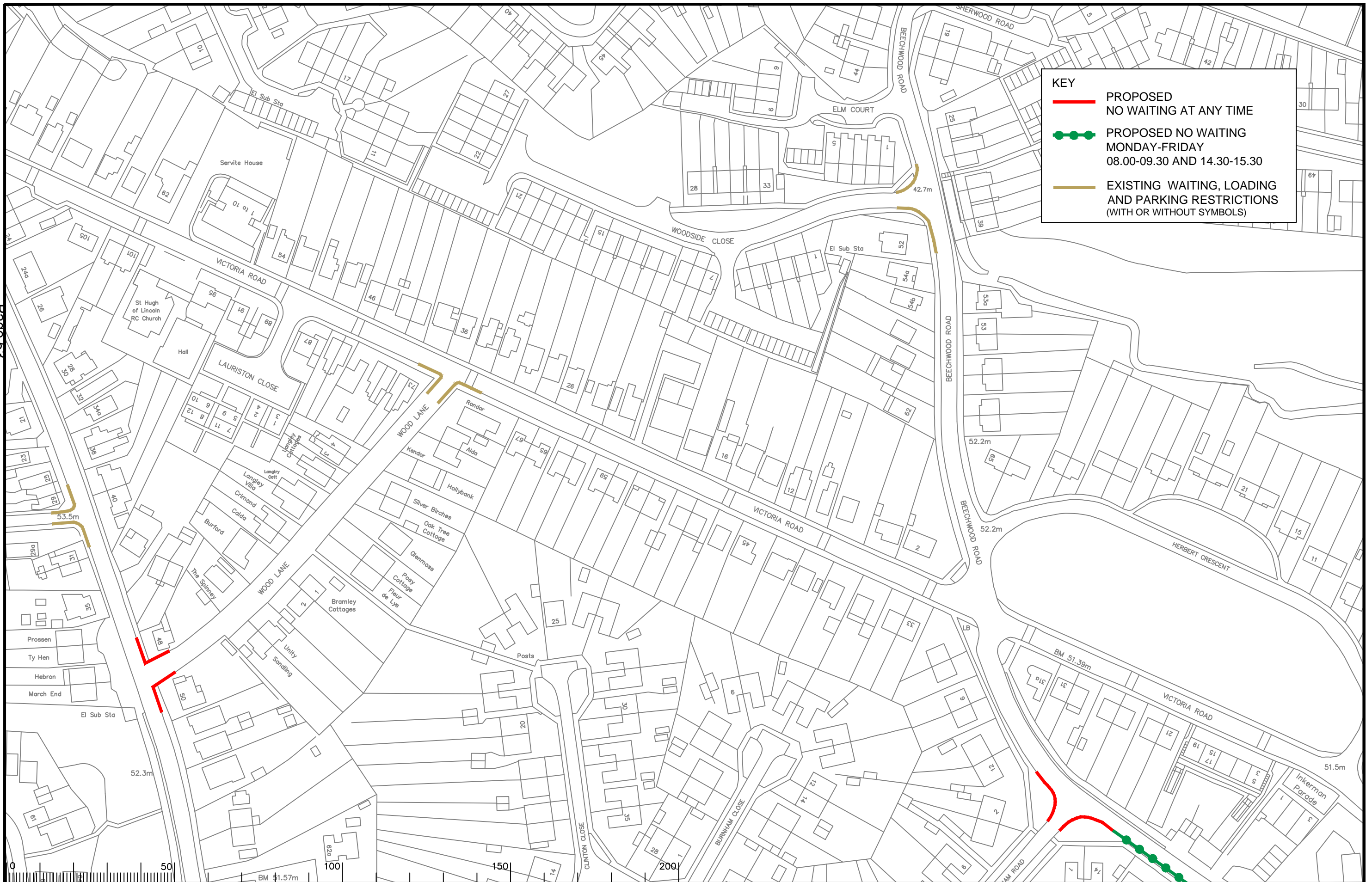

KEY

- PROPOSED NO WAITING AT ANY TIME
- PROPOSED NO WAITING MONDAY-FRIDAY 08.00-09.30 AND 14.30-15.30
- EXISTING WAITING, LOADING AND PARKING RESTRICTIONS (WITH OR WITHOUT SYMBOLS)

Notes

Rev.	Description	Drwn	Sig.	Date	Chkd	Sig.	Date	Appr	Sig.	Date
A	RESTRICTIONS AMENDED	CAH	CAH	08.14	PW	PW	08.14	RH	RH	08.14
B	RESTRICTIONS AMENDED	CAH	CAH	11.15	PW	PW	11.15	RH	RH	11.15

Rev.	Description	Drwn	Sig.	Date	Chkd	Sig.	Date	Appr	Sig.	Date
A	RESTRICTIONS AMENDED	CAH	CAH	08.14	PW	PW	08.14	RH	RH	08.14
B	RESTRICTIONS AMENDED	CAH	CAH	11.15	PW	PW	11.15	RH	RH	11.15

North Point

Based upon the Ordnance Survey mapping with the permission of the Controller of Her Majesty's Stationery Office. Crown copyright. Unauthorised reproduction infringes Crown copyright and may lead to prosecution or civil proceedings. Surrey County Council LA 076872 1996.

Drawn by	Sig.	Date
CAH	CAH	11/11

Checked by	Sig.	Date
JAR	JAR	11/11

Approved by	Sig.	Date
TPC	TPC	11/11

Project

KNAPHILL DPE WOKING

Implemented Traffic Orders

SHEET OF

SURREY COUNTY COUNCIL
Sustainable Development
Head of Transport
Roadway Control Unit

Project No.	3282/WOK
Contract Sheet No.	20107
Rev.	B
Classification	PROPOSAL

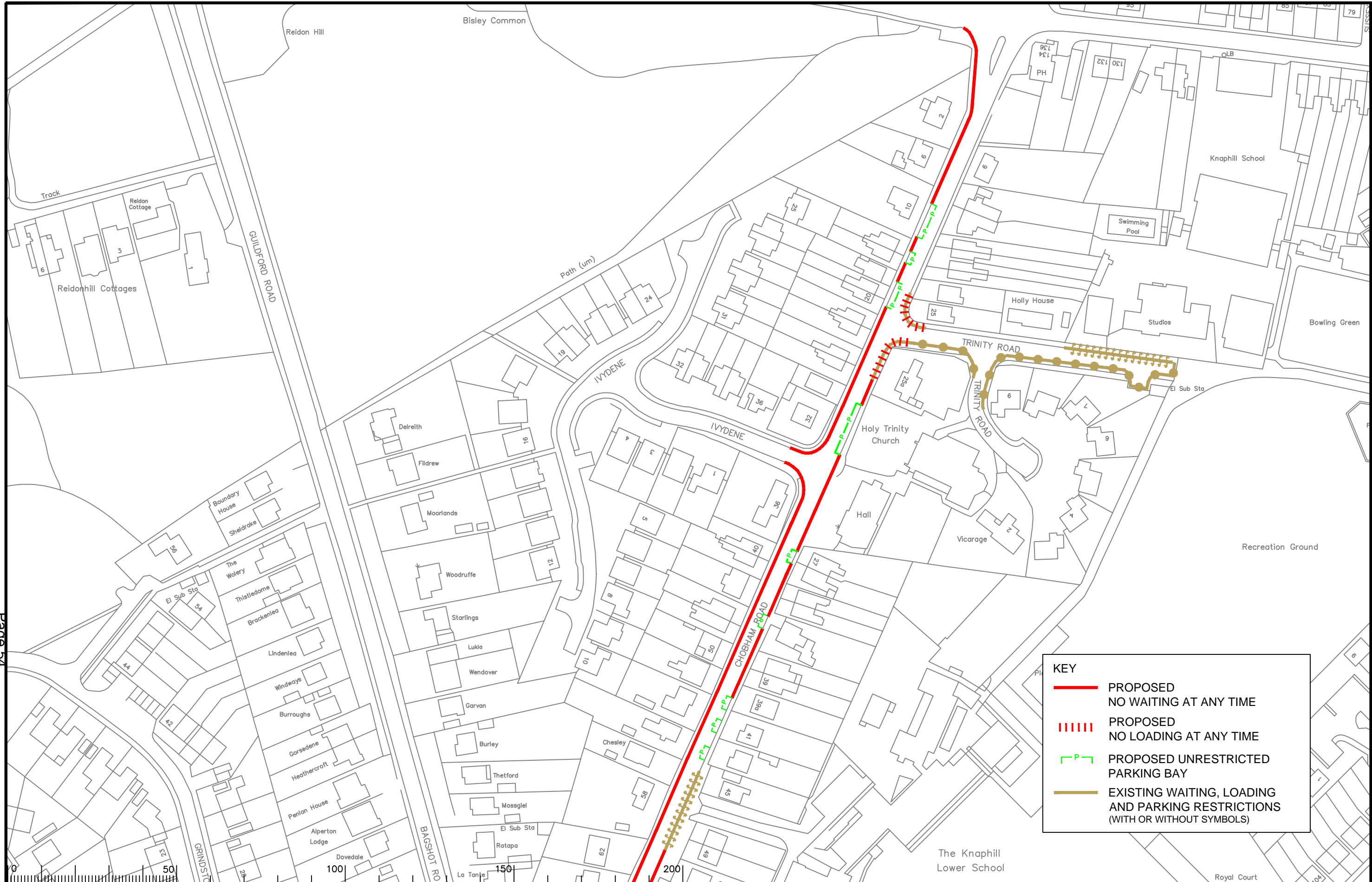

KEY

- PROPOSED NO WAITING AT ANY TIME
- - - - - PROPOSED NO LOADING AT ANY TIME
- P - PROPOSED UNRESTRICTED PARKING BAY
- - - - - EXISTING WAITING, LOADING AND PARKING RESTRICTIONS (WITH OR WITHOUT SYMBOLS)

Page 54

Notes

Rev.	Description	Drwn	Sig.	Date	Chkd	Sig.	Date	Appr	Sig.	Date
A	Amendment to Trinity Road restrictions	SDC	SDC	08.02.08	AM	AM	08.02.08	TPC	TPC	08.02.08
B	WAITING RESTRICTIONS AND LINETYPES AMENDED	AJM	AJM	18.12.07	KP	KP	18.12.07	TPC	TPC	18.12.07
C	WAITING RESTRICTIONS AMENDED	SDC	SDC	29.07.08	SDC	SDC	29.07.08	TPC	TPC	29.07.08
D	RESTRICTIONS AMENDED	CAH	CAH	08.14	PW	PW	08.14	RH	RH	08.14
E	RESTRICTIONS AMENDED	CAH	CAH	11.15	PW	PW	11.15	RH	RH	11.15

Drwn	Sig.	Date	Chkd	Sig.	Date	Appr	Sig.	Date
SDC	SDC	08.02.08	AM	AM	08.02.08	TPC	TPC	08.02.08
AJM	AJM	18.12.07	KP	KP	18.12.07	TPC	TPC	18.12.07
SDC	SDC	29.07.08	SDC	SDC	29.07.08	TPC	TPC	29.07.08
CAH	CAH	08.14	PW	PW	08.14	RH	RH	08.14
CAH	CAH	11.15	PW	PW	11.15	RH	RH	11.15

North Point

Drawn by	Sig.	Date	Checked by	Sig.	Date	Approved by	Sig.	Date
SDC	SDC	05/05	AM	AM	05/05	TPC	TPC	05/05

Project: **KNAPHILL DPE WOKING**

Implemented Traffic Orders

SHEET 21 of 21

SURREY COUNTY COUNCIL
Sustainable Development

Project No. **3282/WOK**
Contract Sheet No. **20021**
Drawing No. **20021**
Rev. **E**
Classification **PROPOSAL**

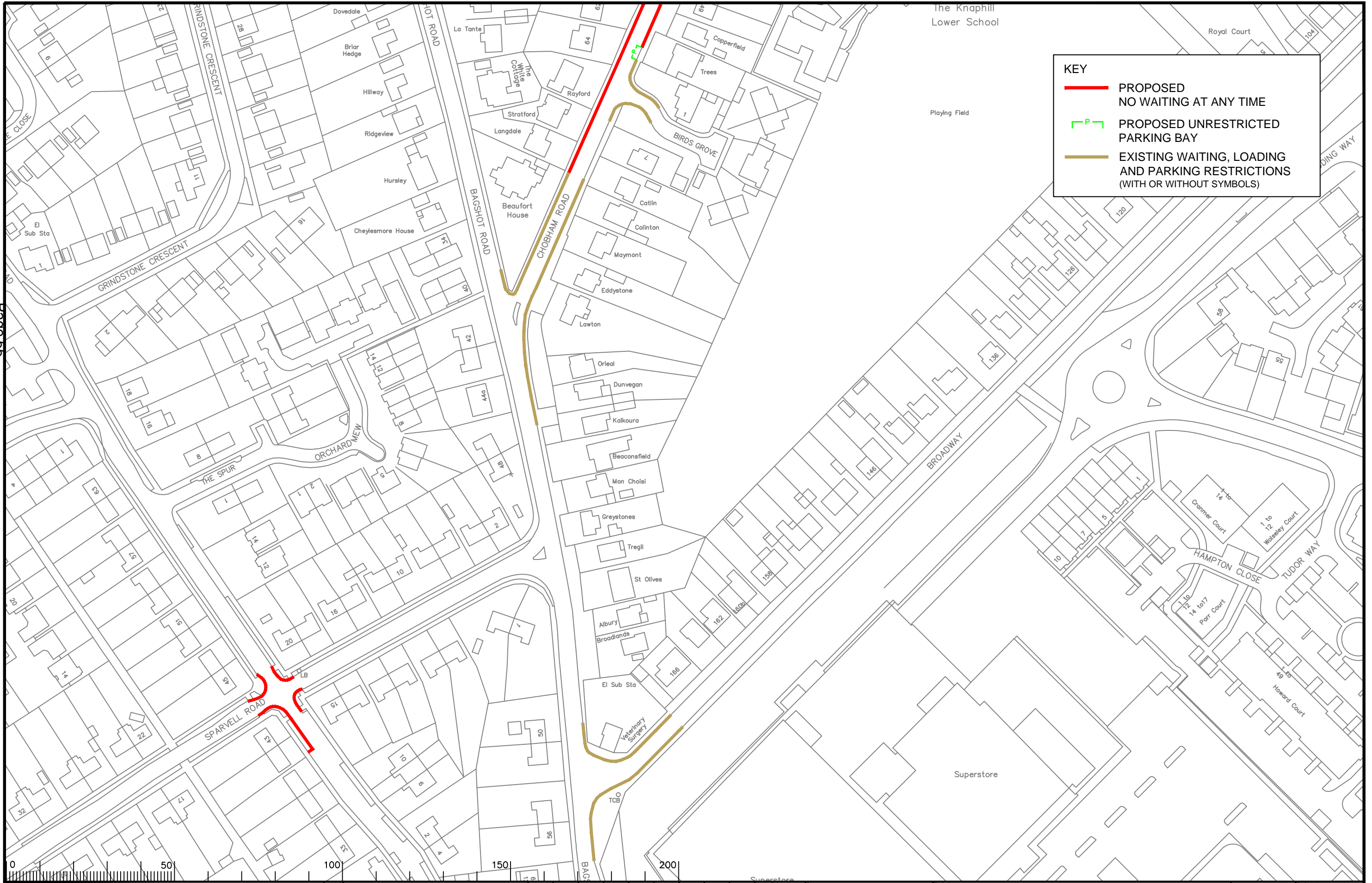

KEY

- PROPOSED NO WAITING AT ANY TIME
- P PROPOSED UNRESTRICTED PARKING BAY
- EXISTING WAITING, LOADING AND PARKING RESTRICTIONS (WITH OR WITHOUT SYMBOLS)

Notes

Rev.	Description	Drwn	Sig.	Date	Chkd	Sig.	Date	Appr	Sig.	Date
A	RESTRICTIONS AMENDED	CAH	CAH	08.14	PW	PW	08.14	RH	RH	08.14
B	RESTRICTIONS AMENDED	CAH	CAH	11.15	PW	PW	11.15	RH	RH	11.15

Rev.	Description	Drwn	Sig.	Date	Chkd	Sig.	Date	Appr	Sig.	Date
A	RESTRICTIONS AMENDED	CAH	CAH	08.14	PW	PW	08.14	RH	RH	08.14
B	RESTRICTIONS AMENDED	CAH	CAH	11.15	PW	PW	11.15	RH	RH	11.15

Based upon the Ordnance Survey mapping with the permission of the Controller of Her Majesty's Stationery Office. Crown copyright. Unauthorised reproduction infringes Crown copyright and may lead to prosecution or civil proceedings. Surrey County Council LA 076872 1996.

Drawn by	Sig.	Date	Checked by	Sig.	Date	Approved by	Sig.	Date
CAH	CAH	01/11	JAR	JAR	01/11	TPC	TPC	01/11

Project: **KNAPHILL DPE WOKING**

Implemented Traffic Orders

SHEET OF

SURREY COUNTY COUNCIL
Sustainable Development

Project No. **3282/WOK**
Contract Sheet No. **20105**
Drawing No. **20105**
Rev. **B**
Classification **PROPOSAL**

This page is intentionally left blank