

**NOTES**

[Symbol]	Existing cover	[Symbol]	Existing kerb	[Symbol]	Existing kerb to be raised to new kerb location
[Symbol]	Existing gully	[Symbol]	Proposed new kerb	[Symbol]	Proposed kerb to new kerb location
[Symbol]	Existing gully location	[Symbol]	Proposed kerb to new kerb location	[Symbol]	Proposed kerb to new kerb location
[Symbol]	Existing cover to be raised to new kerb location	[Symbol]	Proposed kerb to new kerb location	[Symbol]	Proposed kerb to new kerb location
[Symbol]	Existing kerb to be raised to new kerb location	[Symbol]	Proposed kerb to new kerb location	[Symbol]	Proposed kerb to new kerb location
[Symbol]	New kerb location	[Symbol]	Proposed kerb to new kerb location	[Symbol]	Proposed kerb to new kerb location
[Symbol]	Existing kerb to be raised to new kerb location	[Symbol]	Proposed kerb to new kerb location	[Symbol]	Proposed kerb to new kerb location
[Symbol]	New kerb location	[Symbol]	Proposed kerb to new kerb location	[Symbol]	Proposed kerb to new kerb location

Rev.	Description	Dr-wn	Sig.	Date	Chkd	Sig.	Date	Appr	Sig.	Date
A	Ship line moved 0.3m in advanced of the ramp	NK	NK	20/01/17	JM	JM	20/01/17	JD	JD	20/01/17
North Point Based upon the Ordinance Survey mapping with Project 10/01/16. Permission of the Controller of Her Majesty's Patent Office is hereby granted to publish this map. All other rights reserved. Reproduction infringes Crown Copyright and may lead to prosecution or civil proceedings. Drawn by: NK, SJP, JD, Date: 10/10/16 Checked by: JD, Date: 10/10/16 Approved by: JD, Date: 10/10/16										
A322 Bridge Street J/W Onslow Street Option 1 Design Proposal for 3 no. Road Tables										
Project No: PC0745 Contract: PC0745_01 Drawing No: A Classification: DESIGN										

SHEET 1 OF 1

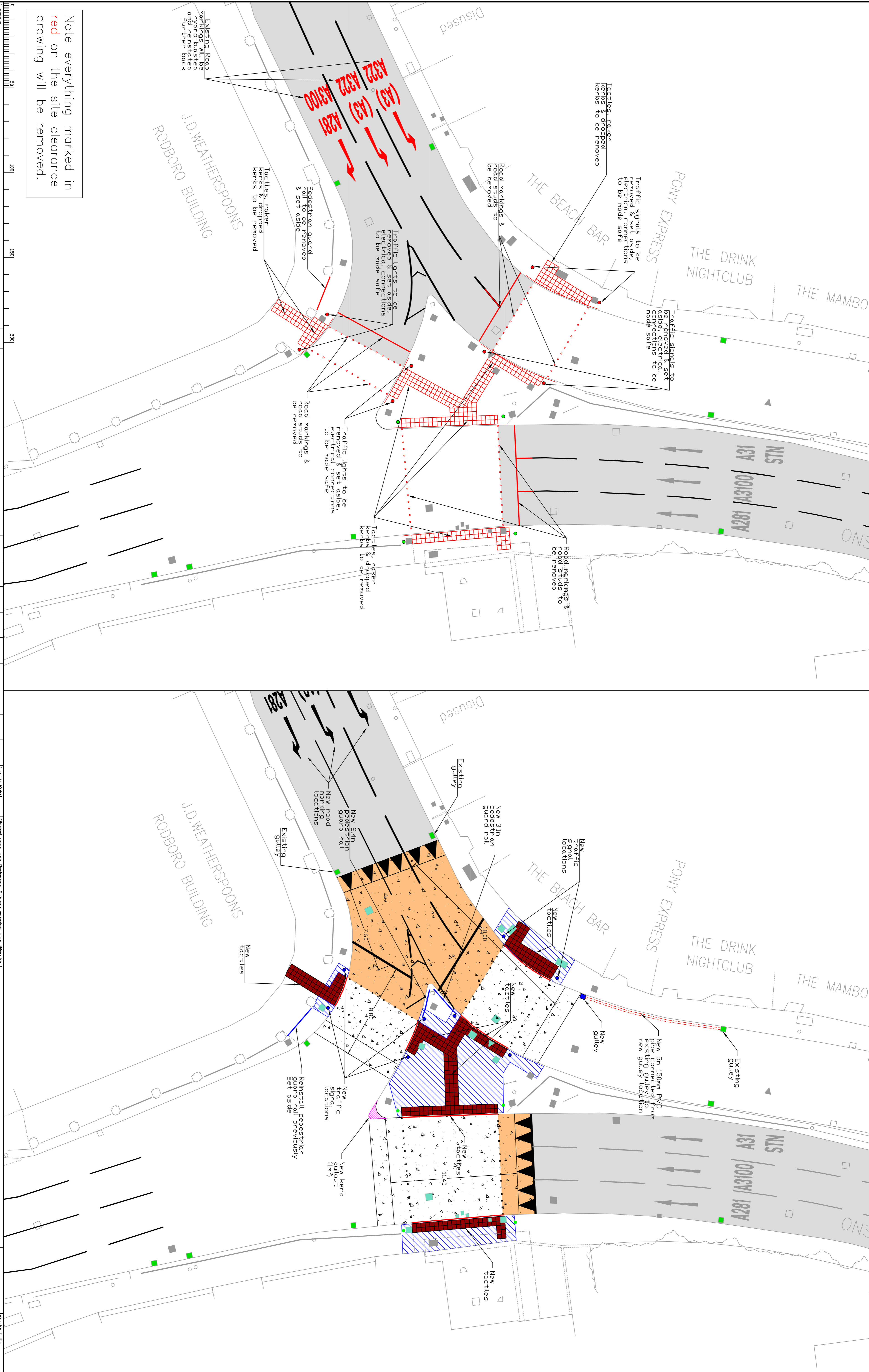

Note everything marked in red on the site clearance drawing will be removed.

NOTES

	Existing cover		Proposed new kerb bullout (1m)
	Existing gully		Proposed pedestrian guard rail
	New gully location		Proposed new road table
	Existing cover to be raised to new kerb level of road		Proposed pedestrian guard rail
	Existing kerb to be raised to new kerb level of road		Proposed pedestrian guard rail
	New kerb location		Proposed pedestrian guard rail
	Existing kerb to be raised to new kerb level of road		Proposed pedestrian guard rail
	New kerb location		Proposed pedestrian guard rail
	Existing kerb to be raised to new kerb level of road		Proposed pedestrian guard rail
	New kerb location		Proposed pedestrian guard rail

Rev.	Description	Drwn	Sig.	Date	Chkd	Sig.	Date	Appr	Sig.	Date

Scale: See Drawing

North

Based upon the Ordnance Survey map with Project permission of the Controller of Her Majesty's Stationery Office. Reproduction in any form without the permission of the Controller of Her Majesty's Stationery Office is prohibited.

Drawn by	JD	10/10/16
Checked by	NK	10/10/16
Approved by	JD	10/10/16

A322 Bridge Street J/W  
Onslow Street

Option 2 Design Proposal  
for 2 no. Road Tables

SHEET 1 OF 1

**SURREY**  
COUNTY COUNCIL  
Surrey Council  
Surrey County Council

Project No.  
PC0745

Contract  
PC0745\_02

Classification  
DESIGN