

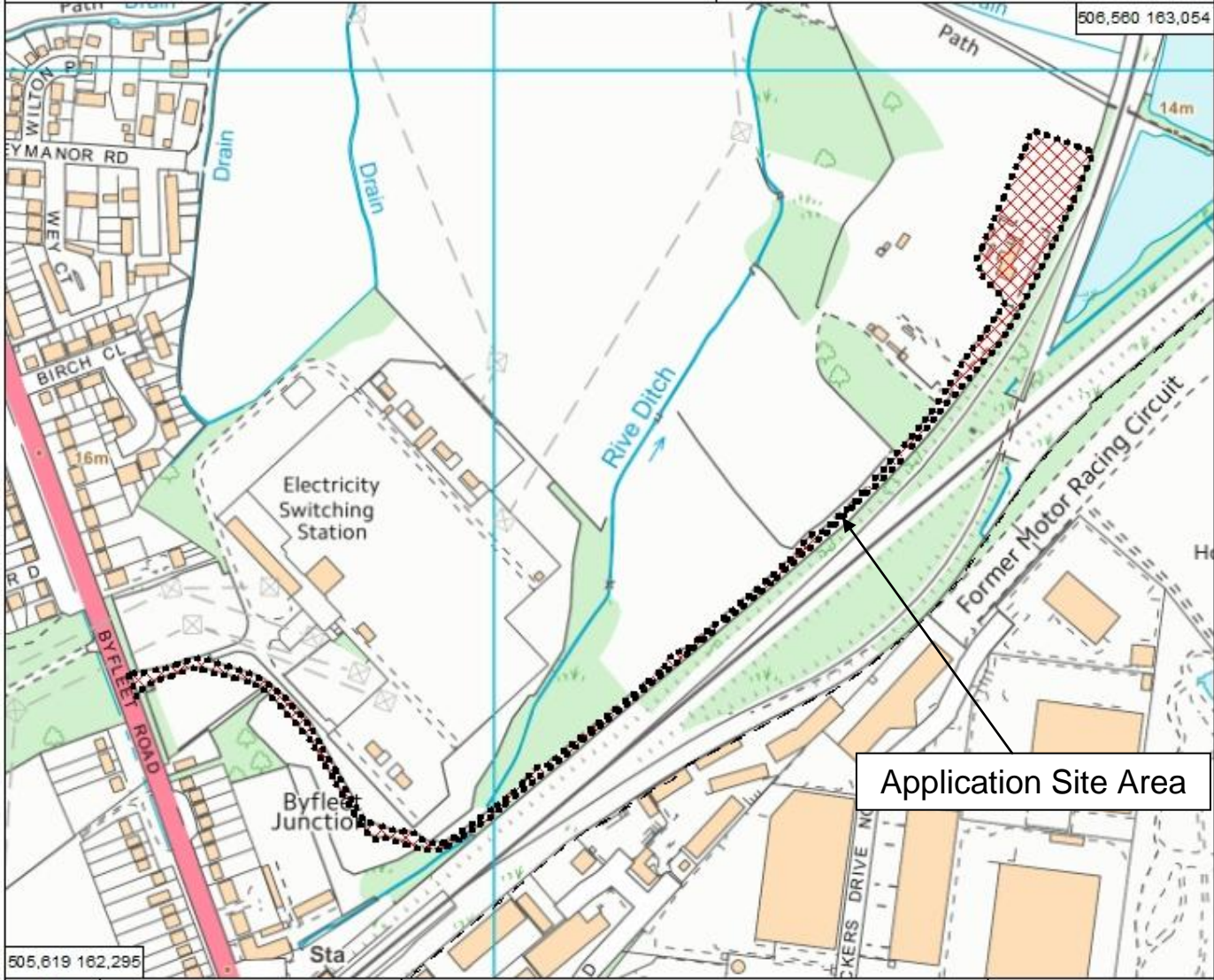

<p style="text-align: center;">Site Location</p>  <p>Scale 1:65,660</p>	<p>Addlestone Quarry, National Grid Entrance, Byfleet Road, New Haw, Surrey KT15 3LA</p> <p>The use of land for the importation of construction, demolition and excavation (C, D & E) waste and the siting of an aggregate recycling facility, involving the placement of mobile crushing and screening plant to enable the recovery of recycled aggregates for sale and export, for a temporary period until 31 December 2020.</p> <p>Application No(s): RU.16/1960</p> <p>Electoral Division(s): Woodham & New Haw, 14026</p>
--	--

© Crown copyright. All rights reserved Surrey County Council, 100019613, 2017

This plan is for indicative purposes only

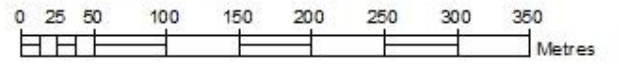

 <p>GRID NORTH</p>	<p>Ref No: SCC REF 2016/0210</p> <p>Date printed: 27/02/2017</p>	 <p>0 25 50 100 150 200 250 300 350 Metres</p>	<p>Scale 1:4,900</p>
---	--	--	----------------------

This page is intentionally left blank