

Section 1
Scale 1:2,500

Signage Details

Knoll Road	4100 CTMP 03
Home Farm	4100 CTMP 04
Logmore Lane	4100 CTMP 05
Robbing Gate	4100 CTMP 06
Site Entrance North	4100 CTMP 07
Site Entrance South	4100 CTMP 08
Anstie Lane	4100 CTMP 09

- Areas shown thus: Greater than 5.5m width (Class A)
Suitable for two HGVs passing
 - Roads shown thus: Greater than 4.8m width, less than 5.5m width (Class B)
Suitable for HGV and Car passing
 - Roads shown thus: Less than 4.8m width (Class C)
NOT suitable for HGV and Car passing
- (1.9) Distance in miles from Knoll Road, Dorking
5.03m Width of carriageway

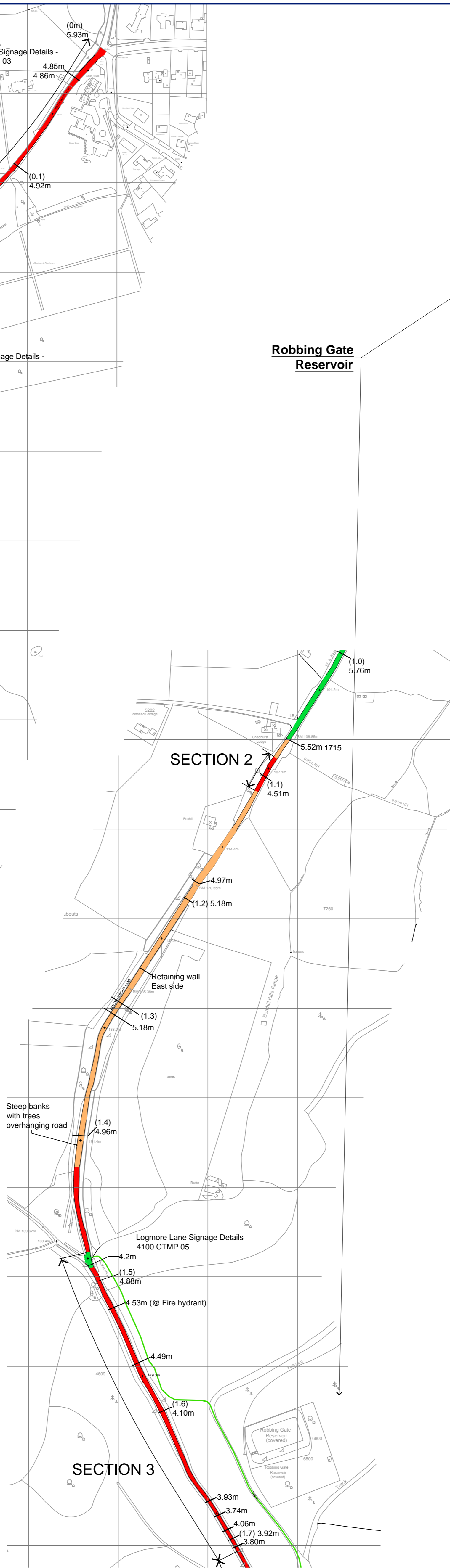

Sections 2 & 3
Scale 1:2,500

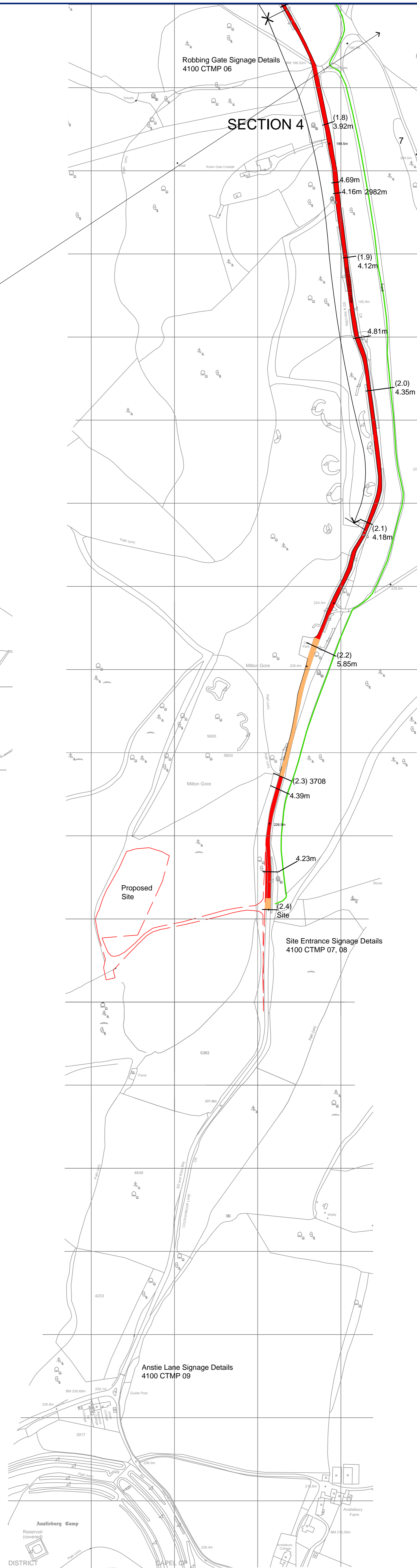

Section 4
Scale 1:2,500

This page is intentionally left blank