

Annex C

Please note that some plans have been rotated 180 degrees to make comparison easier. Please see north arrows and additional annotations.

1845 Dorking to Epsom Railway Plan and Terrier

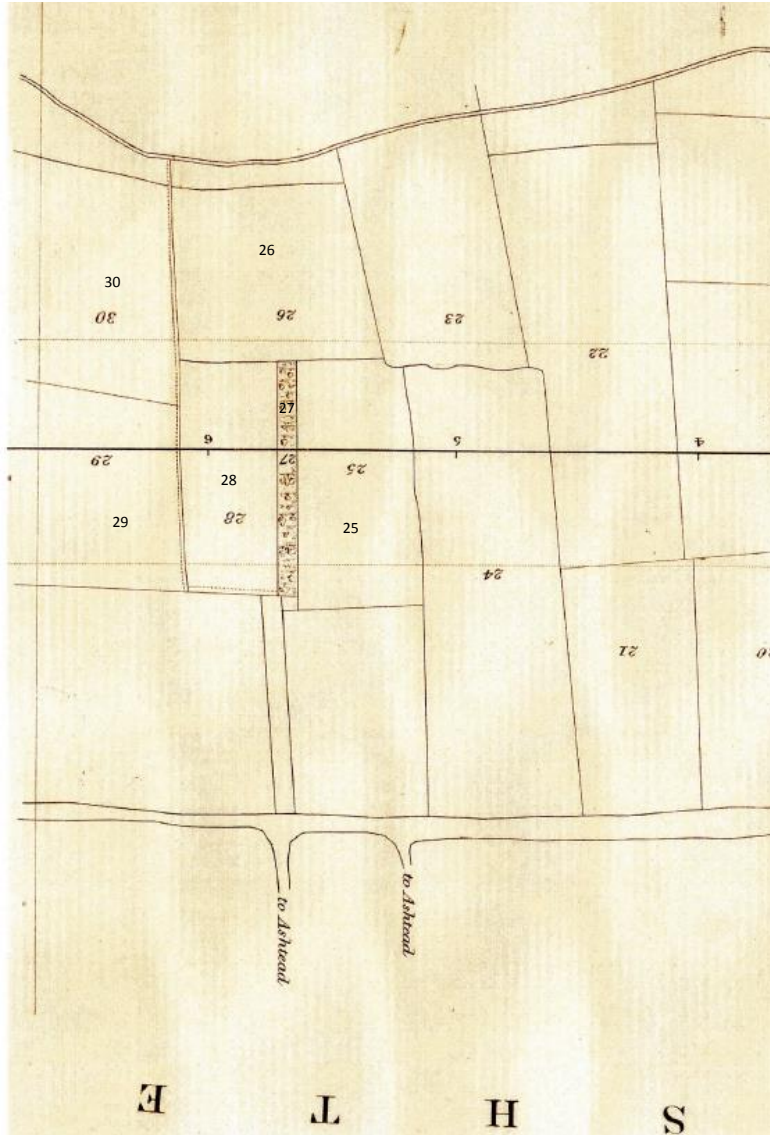

Number on Plan.	Description of Property.	Owners, or Reputed Owners.	Lessees, or Reputed Lessees.	Occupiers.
25	Pasture field	The Hon. Fulk Greville Howard	.	Michael Agate
26	Arable field	The Hon. Fulk Greville Howard	.	Michael Agate
27	Copse, or wood	The Hon. Fulk Greville Howard	.	Michael Agate
28	Arable field and footpath	The Hon. Fulk Greville Howard	.	Michael Agate
29	Arable field and footpath	The Hon. Fulk Greville Howard	.	Michael Agate
30	Pasture field and footpath	The Hon. Fulk Greville Howard	.	Michael Agate

ITEM 7

1955/56 Epsom and Leatherhead Railway Plan and terrier



Numbers referring to the plan.	DESCRIPTION OF PROPERTY.	NAMES of OWNERS or REPUTED OWNERS.	NAMES of LESSEES or REPUTED LESSEES.	OCCUPIERS NAMES.
23	Arable	Honorable Mary Howard		John Agate.
24	Pasture	Honorable Mary Howard		John Agate.
25	Shaw	Honorable Mary Howard		John Agate.
26	Arable	Honorable Mary Howard		John Agate.
27	Arable and occupation Road	Honorable Mary Howard		John Agate.
28	Arable and occupation Road	Honorable Mary Howard		John Agate.
29	Shaw	Honorable Mary Howard.		John Agate.
30	Arable	Honorable Mary		John Agate.

Extract from Conveyance Schedule 1857 with regard to land owned by Mary Howard

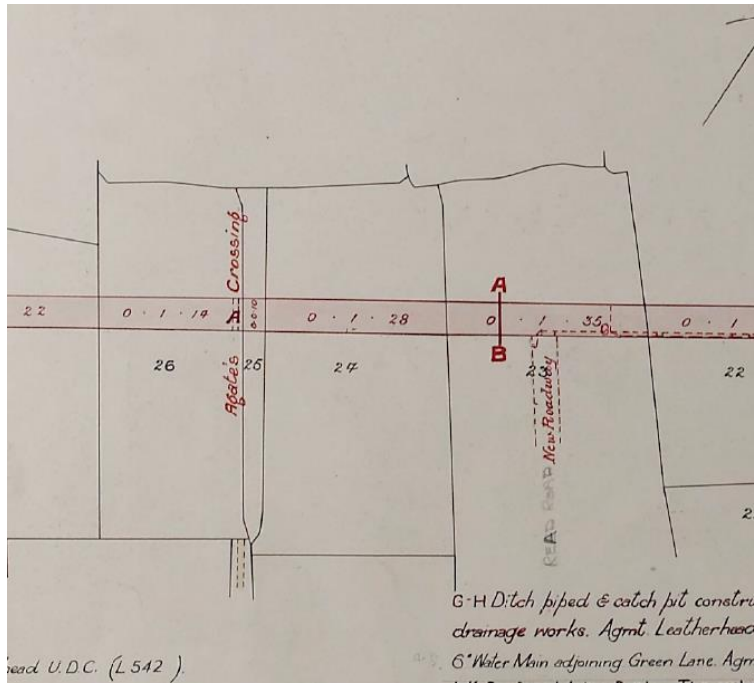

No	Description	A	R	P	
3	Arable land	0	3	30	
6	ditto	0	3	30	
7	ditto	0	3	12	
8	Meadow land	0	2	4	
9	ditto	0	1	10	
10	ditto	0	2	0	
19	ditto	0	2	5	
22	Arable land	0	1	26	
23	ditto	0	1	35	
24	Facture land	0	1	28	
25	Shaw	0	0	10	
26	Arable land	0	1	14	
27	Arable land & Occupation Road	0	2	22	
29	Shaw	0	0	18	
30	Arable land	0	1	30	
31	ditto	0	1	30	
		A	7	3	24

... in view of a bridge under railway in No 8 at point A, 10 ft high.)
 2. Two level crossings in Ashford Woodfield (No 12) and one on the Farm in the occupation of John Agate (No. 26) such crossings to be the usual Field Crossings for carriages and to be placed as required by said Mary Howard.

26. Epson N. L. Co. 22nd Jan^y 1911. Memorandum in respect of the wicket gates provided at this crossing to accommodate pedestrians, the Companies doing so without admitting the right of the public to cross the Line at the point A.

ITEM 7

1955/56 Epsom and Leatherhead Railway Plan showing location of public crossings laid out in Act

(Note that owners or reputed owners are listed as 'Surveyors of Highways' for those units 5 and 13).

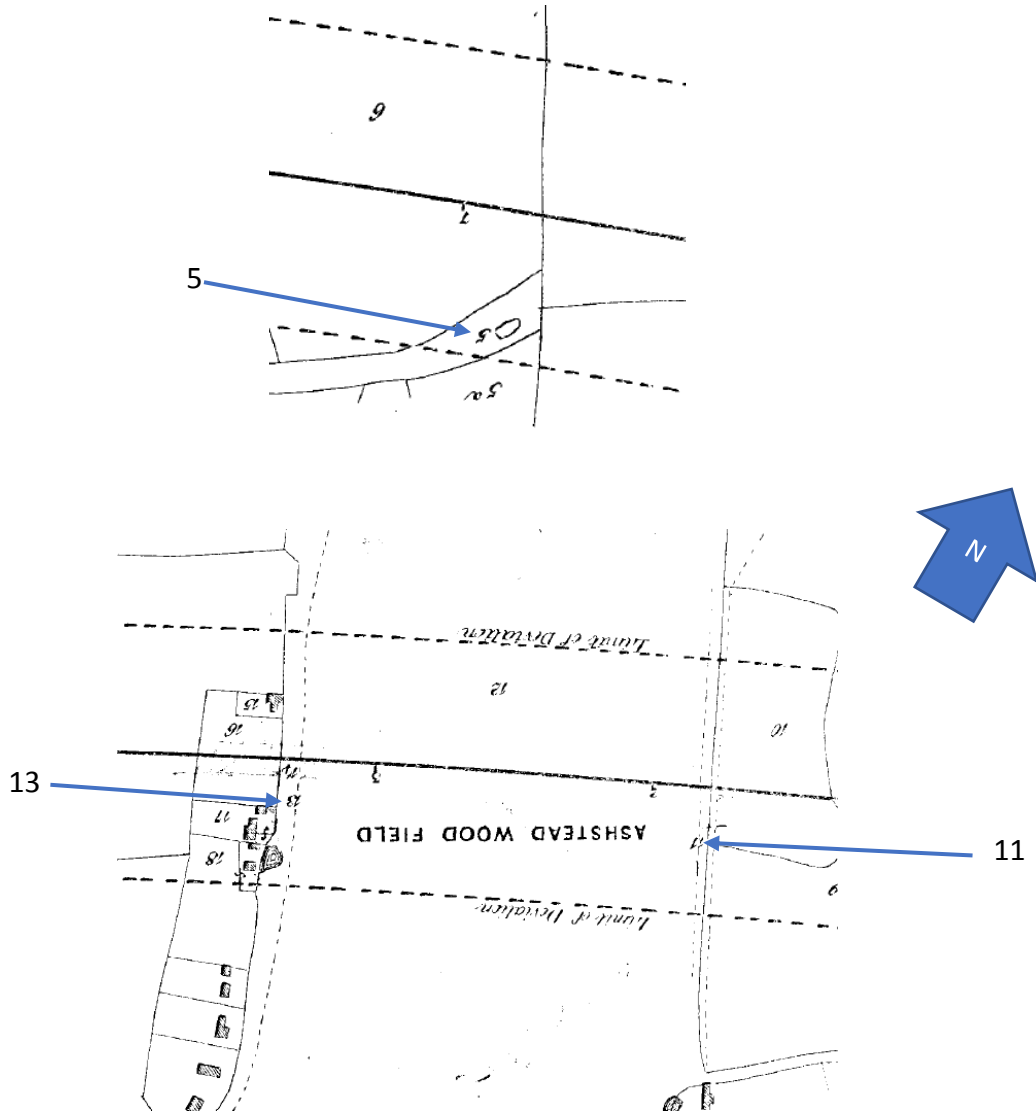

5	Public Highway Waste and Pond.	Surveyors of Highways	
11	Occupation Road	Honorable Mary Howard, Lady of the Manor.	The Freeholders and Copyholders Tenants of the Manor.
12	Waste or Common	Honorable Mary Howard, Lady of the Manor.	The Freeholders and Copyholders Tenants of the Manor.
13	Public footpath	Surveyors of Highways	

1845 Railway Plan with current right of way crossing location overlaid

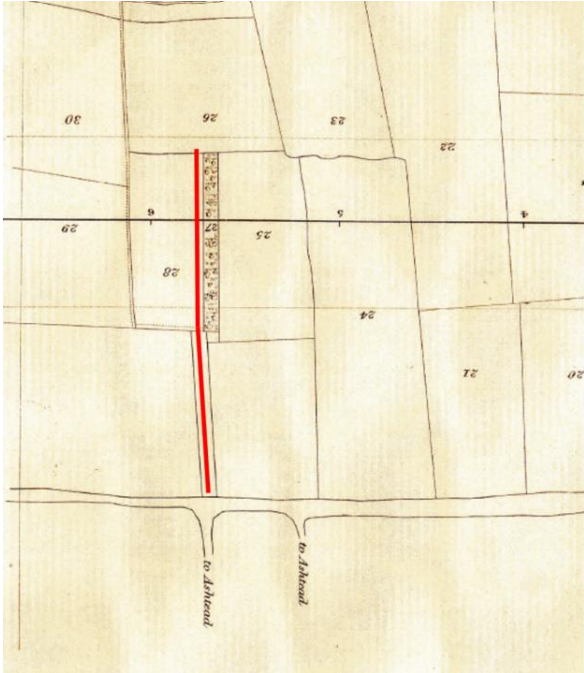

1855/6 Railway Plan with current right of way position shown

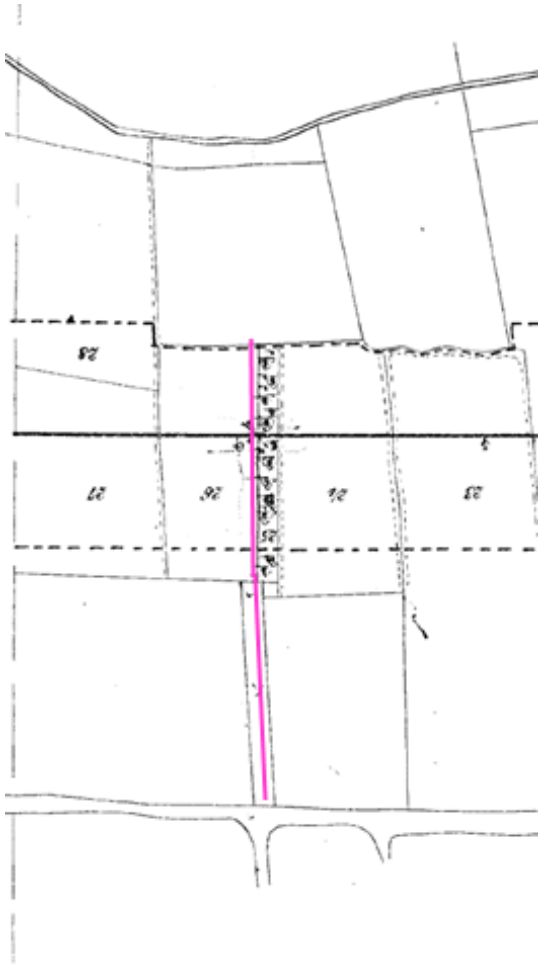

Ordnance Survey County Series First Edition Map 1877, Sheet 18:12

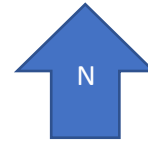
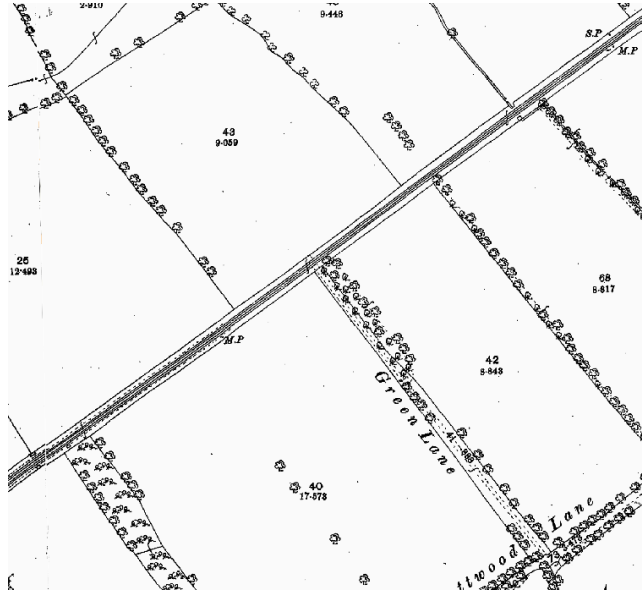

Ordnance Survey County Series First Edition Map 1877 with current right of way position shown

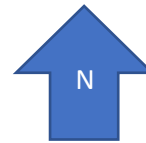
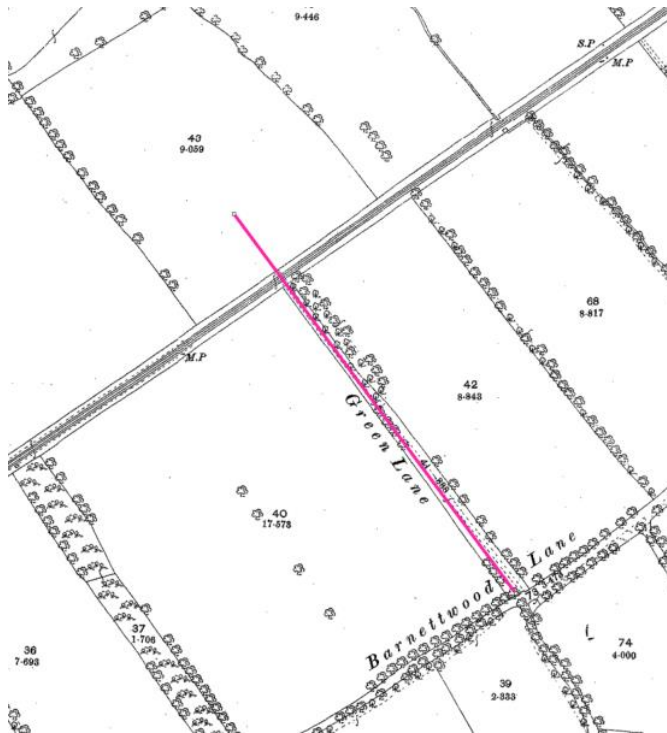

Ordnance Survey County Series First Edition Map 1896, sheet 18:12



Ordnance Survey County Series First Edition Map 1913, sheet 18:12

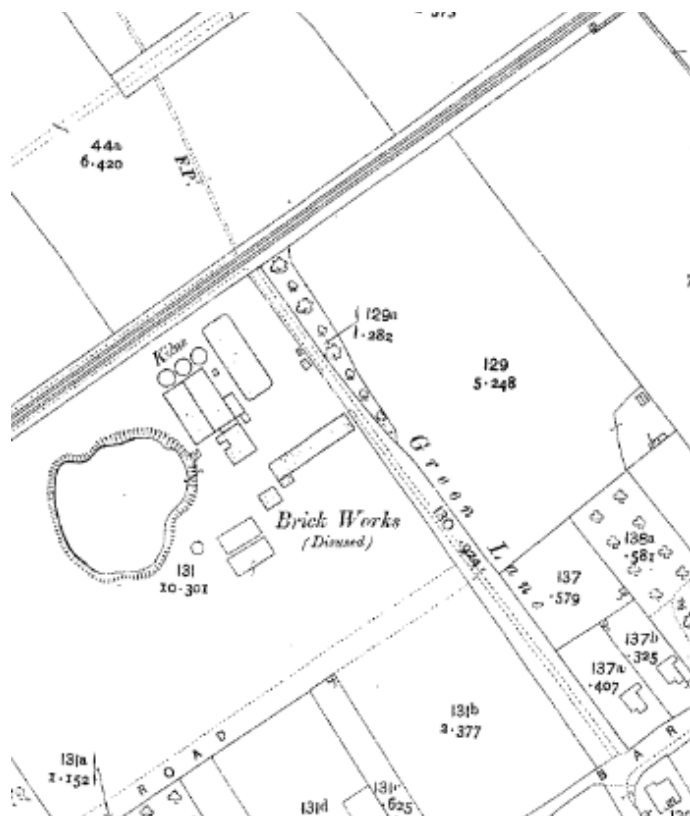

This page is intentionally left blank