

Agenda Items

Item 7 – Auclaye Brickworks, Horsham Road, Capel

(MO/2017/0953)

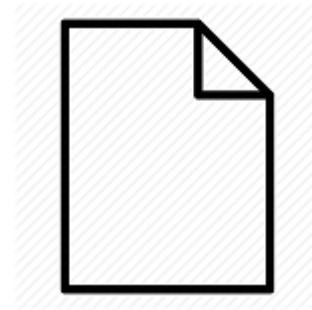



2018 Aerial Photos

Aerial 1 : Auclaye Brickworks, Horsham Road, Capel



2018 Aerial Photos

Aerial 2 : Auclaye Brickworks, Horsham Road, Capel



Page 361





Figure 1 - Knoll Farm Road looking eastwards towards Horsham Road



Figure 2 - Looking westwards from Horsham Road to Knoll Farm Road showing bellmouth



Figure 3 - looking westwards along Knoll Farm Road towards the application site



Figure 4 - eastern half of the application site looking southwards from Knoll Farm Road





Figure 5 - eastern half of the application site looking southwards from Knoll Farm Road



Figure 6 - eastern half of the application site looking southwards with retained trees on the right





Figure 7 - western half of the application site looking southwards with the railway line and Geological SSSI on the right



Figure 8 - western half of the application site looking southeast with the diving tree line on the left





SURREY

Figure 9 - Western Site Boundary and Railway Line to the West (looking south-east)



Figure 10 - Former Brickworks Area (looking south)





Figure 11 - Former Brickworks Area (looking south-west) SURREY





Figure 12 - Former Brickworks Area (looking south-east)





Figure 13 - Security Shed in the North-East of the Former Brickworks Area with Derelict Building Beyond (looking south)





Drawing Ref. AB/102 Site Location Plan Rev. D dated February 2017

Page 375

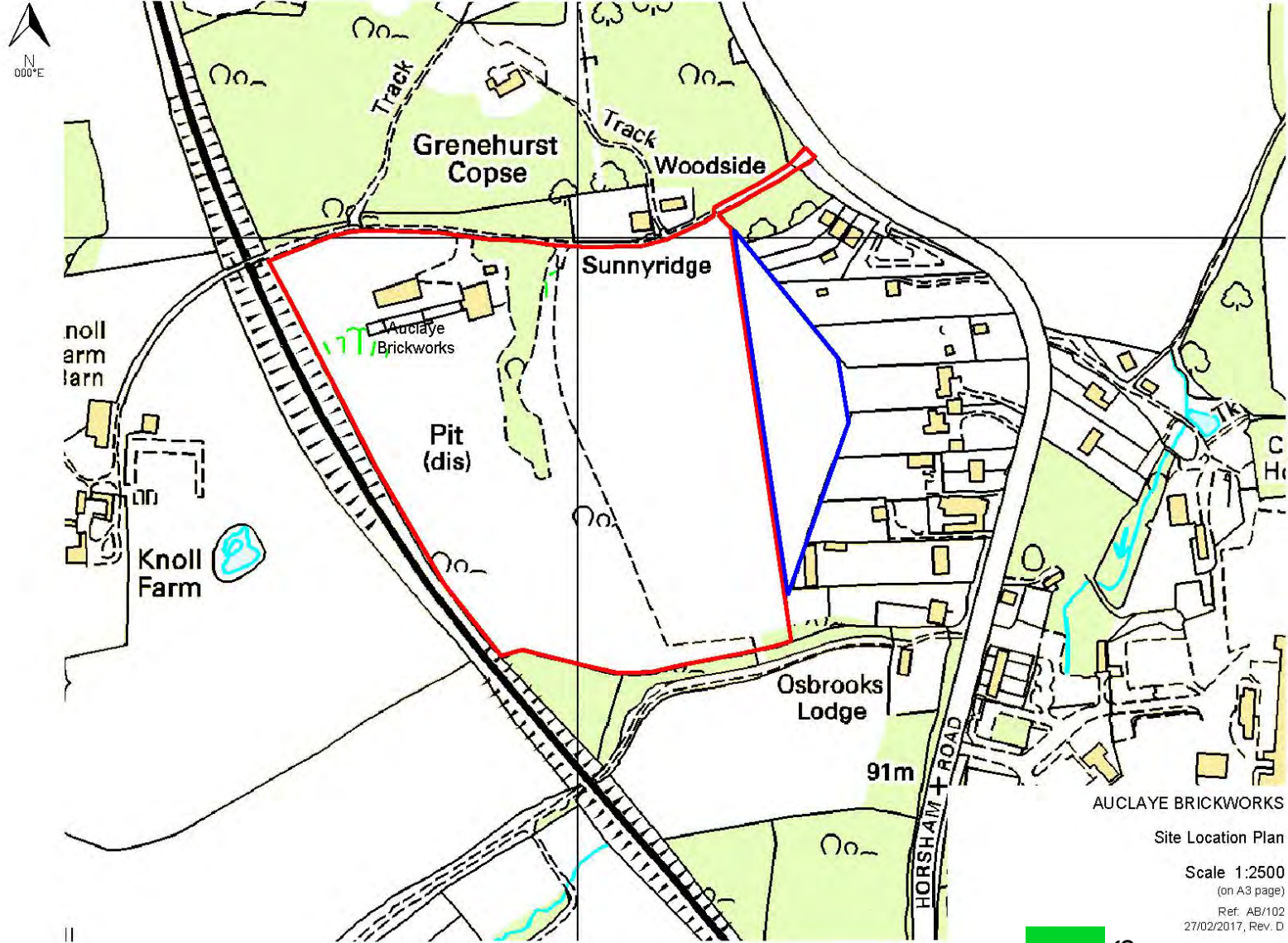

AUCLAYE BRICKWORKS
 Site Location Plan
 Scale 1:2500
 (on A3 page)
 Ref. AB/102
 27/02/2017, Rev. D



Drawing Ref. AB/103 Excavation and Restoration Phasing Plan Rev. G dated December 2017

Page 376

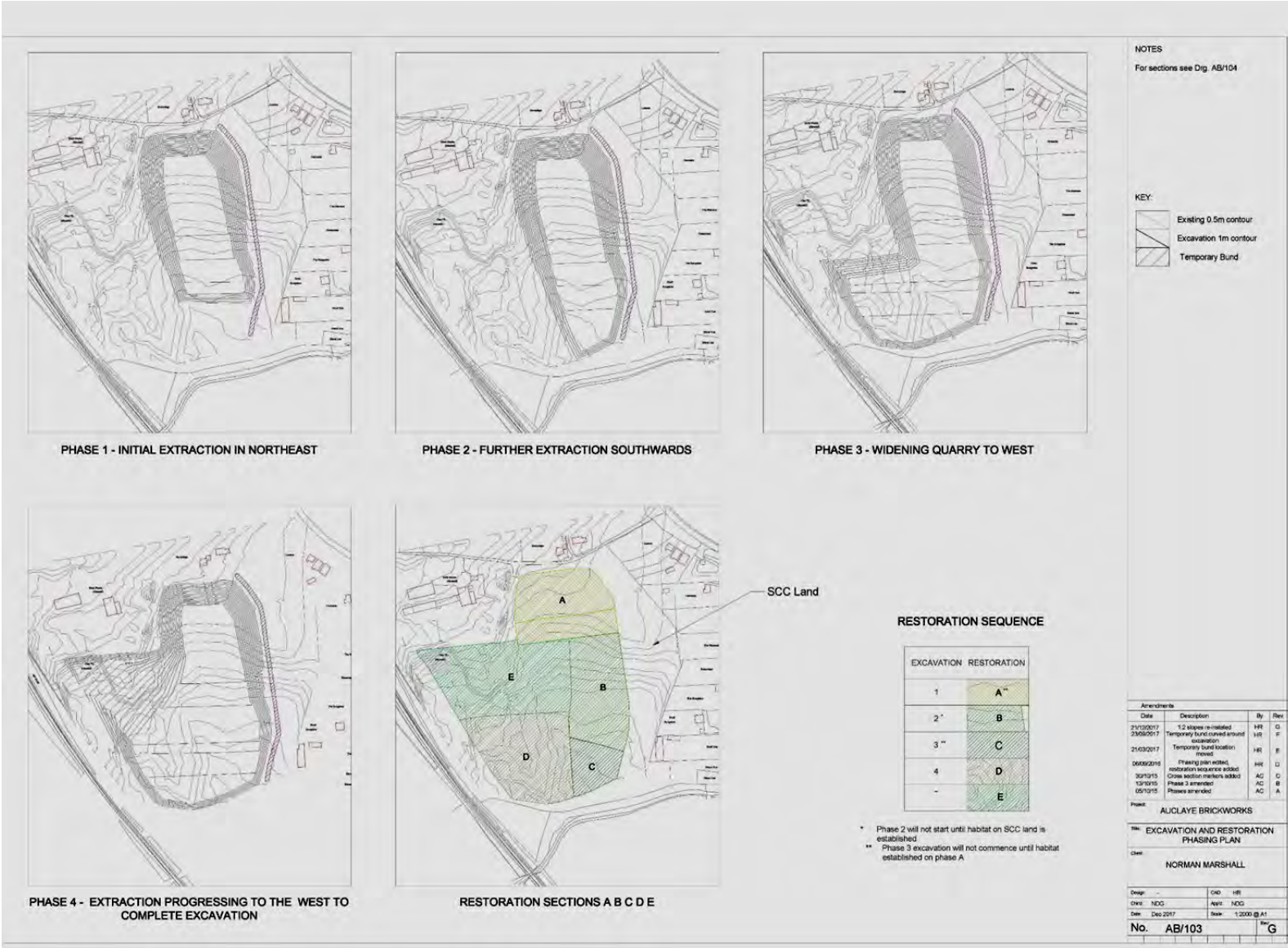

Drawing Ref. AB-107 Location of 2m high bund and 2m high fence Rev. C dated October 2017

Page 377





Drawing Ref. AB-108 Site Compound and Stockpile Location Rev. E dated October 2017

Page 378



Stockpile during Phase 1 (Part 1)



Stockpile during Phase 1 (Part 2)



Stockpile during Phase 2, 3 and 4

NOTES
 1 For details of temporary access road and passing bays see Drg. 2105/25/16/006 Proposed Access Arrangements.
 2 Refer to Drg. AB/103 for details of the quarry phases.

KEY:
 Access Road
 2m high bund (plus 2m fence)
 Excavation zone
 Stockpile

Amendments			
Date	Description	By	Rev
07/04/17	Extended bund to cover southern houses	HR	NDG
05/10/17	Added updated (survey) bund	HR	NDG
04/01/18	Added proposed fence hedge line	HR	NDG
22/02/18	Removed materials recycling area	HR	NDG

Prepared by: **AUCLAYE BRICKWORKS**

Site Name: **Site Compound and Stockpile Location**

Client: **NORMAN MARSHALL**

Drawn by:	CAD	HR
Check:	NDG	April
Date:	February 2018	Scale: 1:2000 @ A1

No. **AB-108** Rev. **E**



Drawing Ref. 3440/DR/001 Sketch Landscape Masterplan

Rev. B dated October 2015

Sketch Landscape Masterplan (restored site)

Norman Marshall

Auclay Brickworks, adj Knoll Farm, Capel, Surrey

This drawing and design are the copyright of Lloyd Bore Landscape Architects. Do not reuse from this drawing.
 All dimensions to be checked on site by contractor prior to commencement of any work.
 All materials, construction and workmanship shall comply with the relevant British Standards. Copies of these are available on the website.

LEGEND

- Existing trees/woodland
- Proposed trees/woodland
- Proposed grassland/scrub
- Proposed tree lined hedgerow
- Proposed pond
- Proposed areas of bare ground
- Proposed arable land



REV: **B** REV DATE: **28/10/15**
 NOTES: **Client details amended**

DRAWING NO: **3440 / DR/001**

DATE AND OWNER: **Norman Marshall, Auclay Brickworks, adj Knoll Farm, Capel, Surrey**

DRAWING BY: **Sketch Landscape Masterplan**

SCALE: **1:1000** DRAWN BY: **LW**
 SHEET: **A1** OF SHEETS: **2B**

lloyd bore

33 ST GEORGE'S PLACE
 CHICHESTER
 KENT CT1 1LT

T: 01207 464 343
 M: 07949 17606
 W: www.lloydbore.co.uk



Drawing Ref. 2015/2516/010 Proposed Access Arrangement and Highway Works Rev. G dated April 2019

Page 380

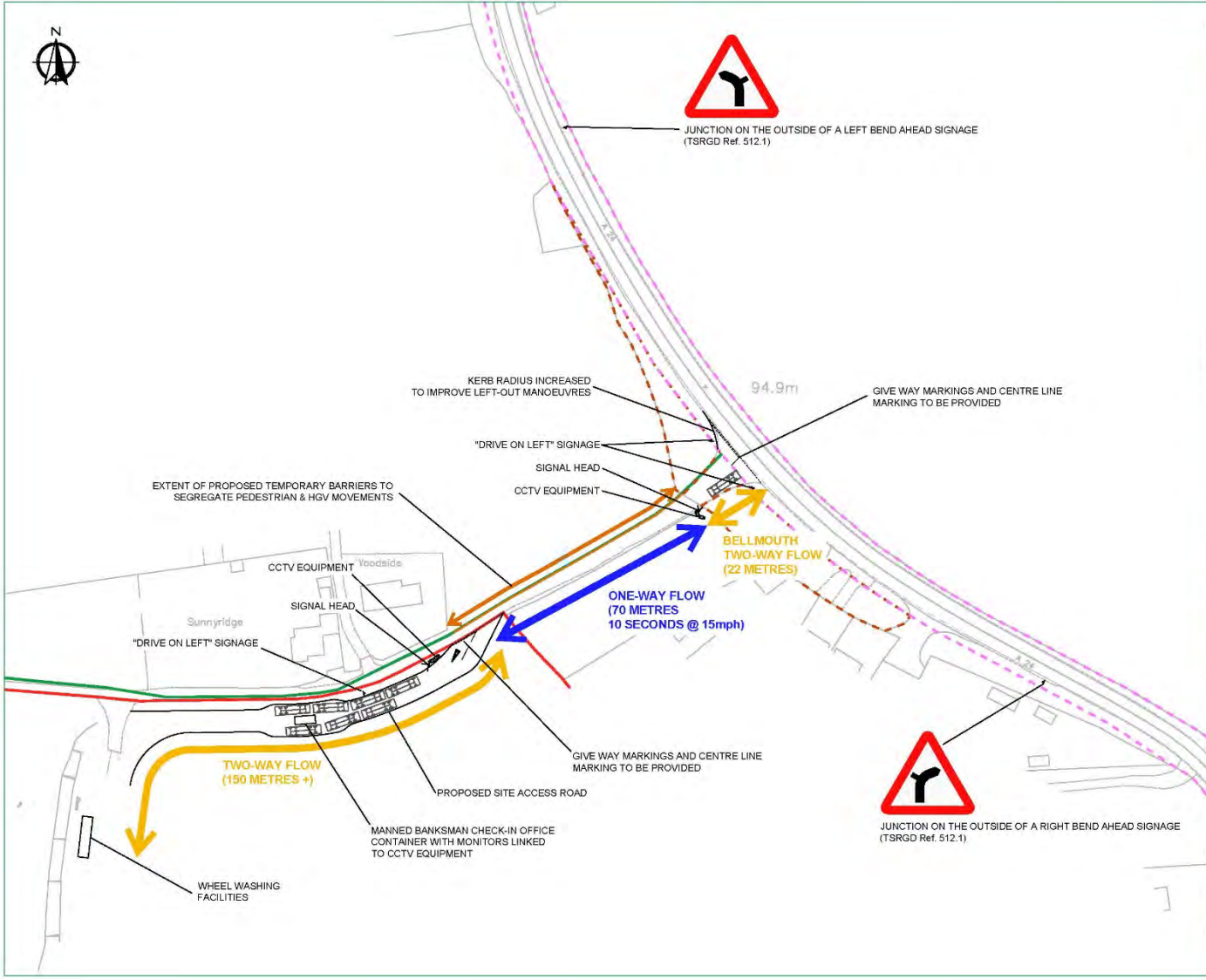

NOTES		A3
LEGEND		
	SITE BOUNDARY	
	EXTENT OF PUBLIC HIGHWAY (BASED ON SCC RECORDS)	
	EXTENT OF COMMON LAND (BASED ON SCC RECORDS)	
	PUBLIC RIGHT OF WAY 178	
RESIDUAL HAZARDS		
<p>The information on this drawing is provided for your information only. It is not intended to be used as a substitute for professional advice or as a basis for any legal proceedings. The user of this drawing is responsible for ensuring that it is used in accordance with the applicable laws and regulations.</p> <p>The drawings are prepared for the purpose of obtaining a planning application and are not to be used for any other purpose without the prior written consent of the author. The author shall not be liable for any loss or damage, whether direct or indirect, arising from the use of these drawings.</p> <p>This map is not a map of any land and does not constitute a statement of any facts. It is provided for information only and should not be relied upon for any legal or other purpose. The accuracy of the information is not guaranteed and the user is responsible for verifying the accuracy of the information.</p>		
<p>rgp Transport Planning and Infrastructure Design Consultants Registered Public and Professional Bodies: www.rgp.co.uk www.rgp.co.uk</p>		
Client	Rural Arisings	
Project	Auclaye Quarry, Capel	
Proposed Access Arrangement and Highway Works		
Scale	Drawn by	Checked by
1:1000	DLH	JCS
Drawn	Checked	Approved
April 2019	23/15/2516/010	CM8
Rev	Rev	Rev
6	6	6