

PLANTING SCHEDULE		SIZE	NOTES	H1	H2	H3	H4	H5	H6	H7	H8	P2	TOTAL
TREES													
Acer campestre	(Field Maple)	0.4m - 0.6m Trans.	All trees and shrubs to be protected by	248	234	130	430	248	217	286	288		2061
Prunus avium	(Wild Cherry)	0.4m - 0.6m Trans.	to be protected by										0
Quercus robur	(Oak)	0.9m - 1.2m Fhd.	1.2m 'Tubex' shelters and planted at 2.1m c/s	4	10	10	6				9		39
Salix alba	(White Willow)	0.9m - 1.2m Fhd.										7	7
TOTAL TREES				248	238	140	440	254	217	266	297	7	2107
SHRUBS													
Cornus sanguinea	(Dogwood)	0.4m - 0.6m Trans.	All hedgerows to be protected by 0.6m 'Tubex' shelters and planted	15	15	10	40	19	16	14	15		144
Corylus avellana	(Hazel)	0.4m - 0.6m Trans.											14319
Crataegus monogyna	(Blackthorn)	0.35m - 0.45m Trans.	at 0.35m c/s in a										20
Prunus spinosa	(Blackthorn)	0.35m - 0.45m Trans.											5
Salix caprea	(Goat Willow)	0.4m - 0.6m Trans.	double staggered row										14498
TOTAL SHRUBS				1365	1624	1245	3090	1875	1641	1874	1784		14498
TOTAL TREES AND SHRUBS				1613	1862	1385	3530	2129	1856	2140	2081	7	16605

Program for Implementation for Planting
 To be carried out in November - March planting season for bare root stock.
 Transplant trees and shrubs to be notch planted.
 Two maintenance visits will be carried out per year during the aftercare period, one in spring and one in early summer.
 Visits will include weed control (including noxious weeds), litter removal and checking and firming up tree shelters.
 A proportion of naturally colonising native woody species such as bramble and elder will be removed.
 Any plants dying during the five year aftercare period will be replaced with a size and species to be agreed with the Mineral Planning Authority to maintain 100% stocking rate during the aftercare period and to achieve a minimum 90% stocking rate upon final restoration.
 Planting to be maintained by use of glyphosate in accordance with manufacturer's instructions to create a 1.0m wide weed free strip. This will permit rapid establishment.
 At the end of the five year post-planting aftercare period, or before should plant growth warrant it, tree shelters will be removed from the planting.

- KEY:
- SITE BOUNDARY
 - EXTRACTION AREA
 - T.P.O
 - EXTRACTION PHASES 1 - 8
 - EXISTING VEGETATION
 - EXISTING SCRUB
 - MOUND OF FORMER WORKINGS
 - ADVANCE PLANTING
 - TPO WOODLAND
 - AREA TO RECOLONISE STOCK FENCE ADDED
 - PROPOSED TREE PLANTING
 - PROPOSED HEDGEROW PLANTING
 - SHALLOW OPEN WATER/MARGINAL VEGETATION
 - RESTORED AGRICULTURAL LAND
 - LAND FOR GRAZING
 - FARM STORAGE AREA
 - AGRICULTURAL ACCESS TRACK
 - RESIDENTIAL ACCESS TRACK
 - FIELD ACCESS GATEWAY
 - PUBLIC RIGHT OF WAY
 - AMPHIBIAN POND
 - WILDLIFE LAKE
 - PROPOSED CONTOURS
 - ORIGINAL GROUND LEVEL
 - UNWORKED MARGINS - ORIGINAL CONTOURS SHOWN

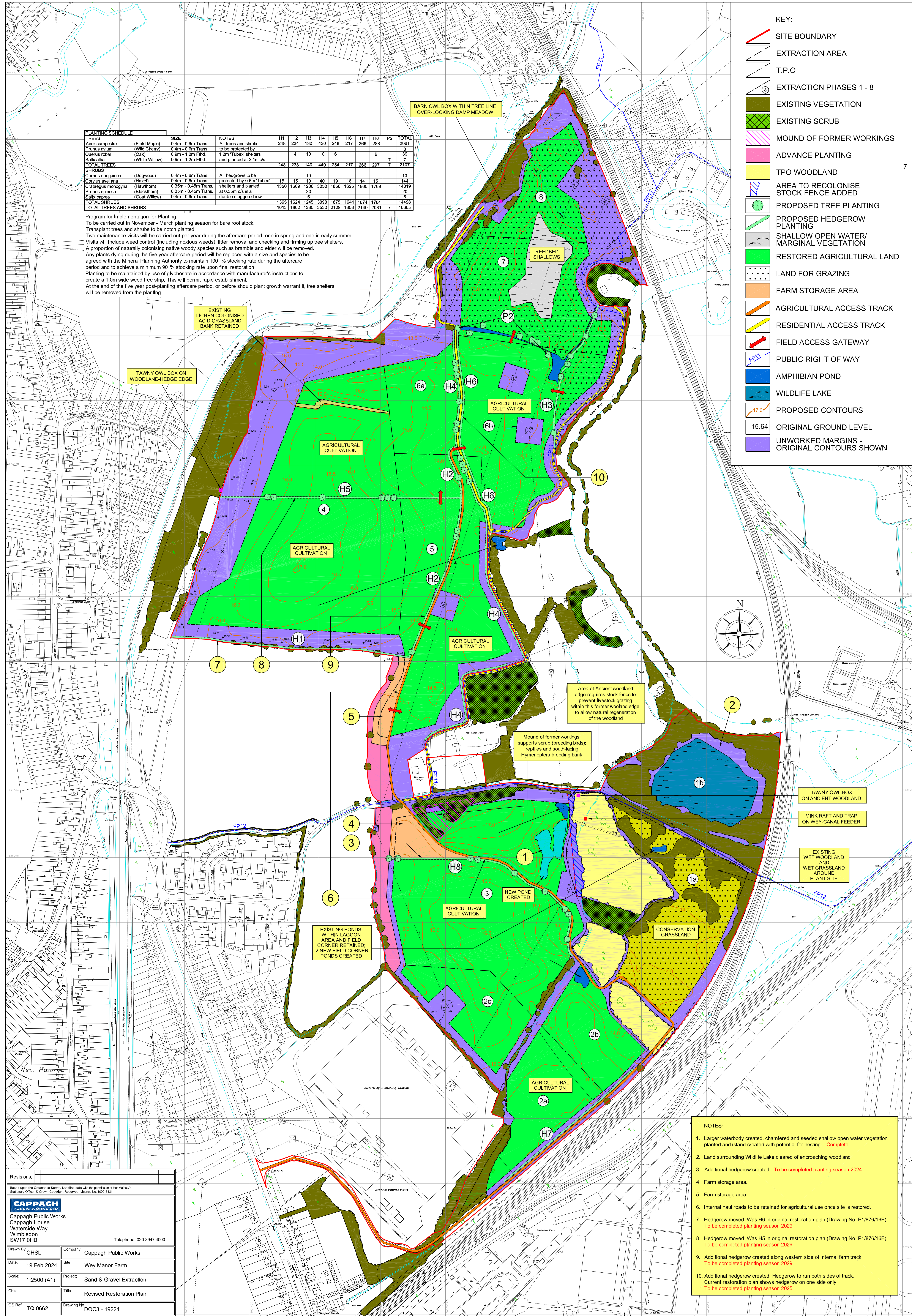

- NOTES:
1. Larger waterbody created, chamfered and seeded shallow open water vegetation planted and island created with potential for nesting. **Complete.**
 2. Land surrounding Wildlife Lake cleared of encroaching woodland
 3. Additional hedgerow created. **To be completed planting season 2024.**
 4. Farm storage area.
 5. Farm storage area.
 6. Internal haul roads to be retained for agricultural use once site is restored.
 7. Hedgerow moved. Was H6 in original restoration plan (Drawing No. P1/876/16E). **To be completed planting season 2023.**
 8. Hedgerow moved. Was H5 in original restoration plan (Drawing No. P1/876/16E). **To be completed planting season 2023.**
 9. Additional hedgerow created along western side of internal farm track. **To be completed planting season 2023.**
 10. Additional hedgerow created. Hedgerow to run both sides of track. Current restoration plan shows hedgerow on one side only. **To be completed planting season 2025.**

Revisions:

Based upon the Ordnance Survey Landline data with the permission of Her Majesty's Stationary Office. © Crown Copyright Reserved. Licence No. 100019131

CAPPACH PUBLIC WORKS LTD
 Cappagh Public Works
 Cappagh House
 Waterside Way
 Wimbeldon
 SW17 0HB
 Telephone: 020 8947 4000

Drawn by: CHSL Company: Cappagh Public Works
 Date: 19 Feb 2024 Site: Wey Manor Farm
 Scale: 1:2500 (A1) Project: Sand & Gravel Extraction
 Chd: Title: Revised Restoration Plan
 OS Ref: TQ 0662 Drawing No: DOC3 - 19224

This page is intentionally left blank