

- KEY:**
- 93.71 Proposed new level
 - 93.71 Existing level
 - Proposed new building / extension
 - Existing building
 - Soft landscaping / grassed areas
 - Hard landscaping areas
 - Existing trees to be retained
 - Existing trees to be removed

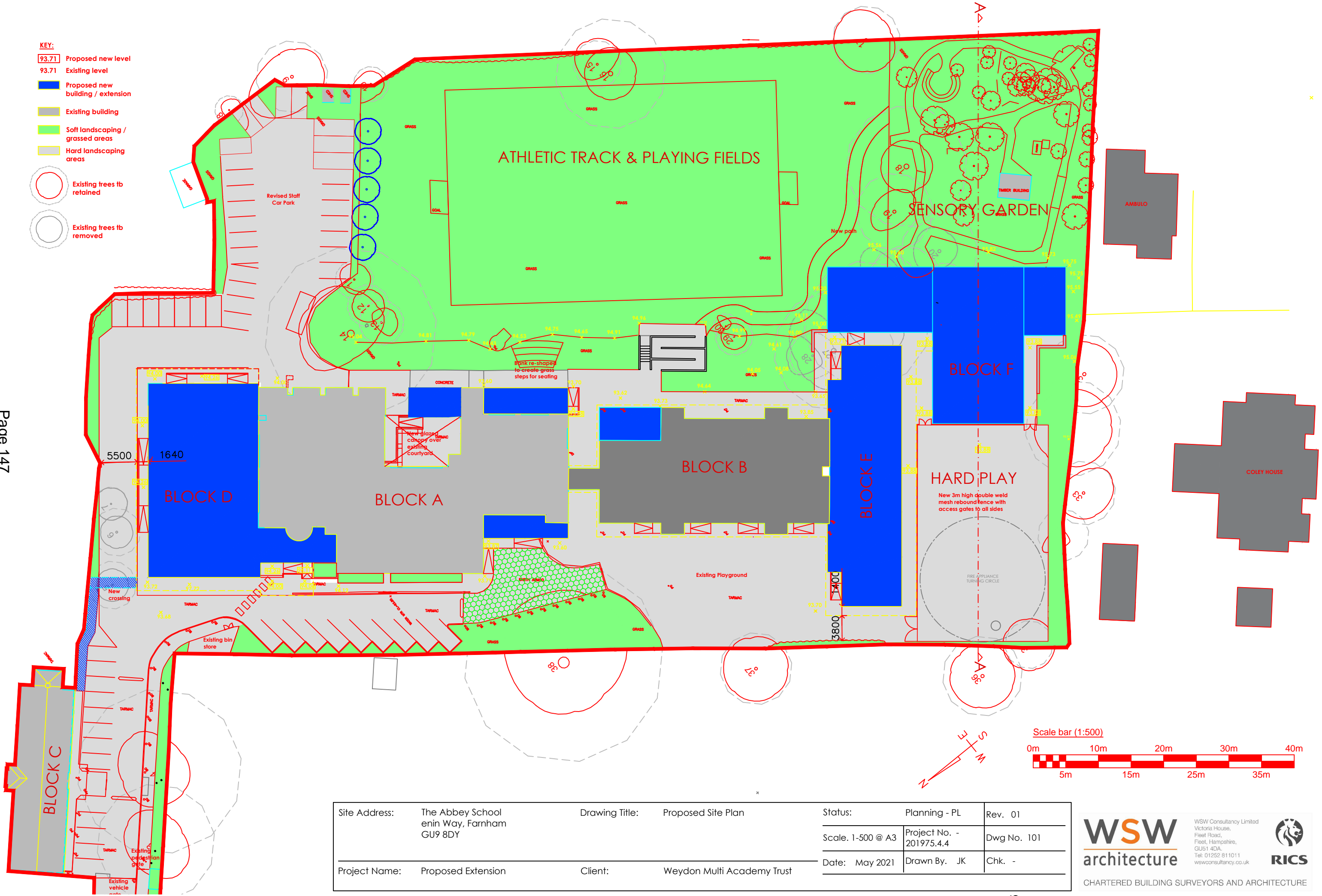

Site Address:	The Abbey School enin Way, Farnham GU9 8DY	Drawing Title:	Proposed Site Plan	Status:	Planning - PL	Rev. 01
Project Name:	Proposed Extension	Client:	Weydon Multi Academy Trust	Scale: 1-500 @ A3	Project No. - 201975.4.4	Dwg No. 101
				Date: May 2021	Drawn By: JK	Chk. -

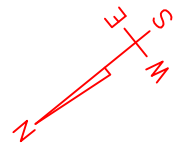
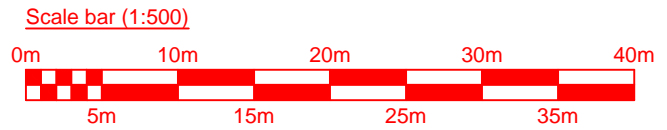

WSW
architecture

WSW Consultancy Limited
Victoria House,
Fleet Road,
Fleet, Hampshire,
GU51 4DA.
Tel: 01252 811011
www.consultancy.co.uk

CHARTERED BUILDING SURVEYORS AND ARCHITECTURE

This page is intentionally left blank